

LT1



LT3 Signal indicator



SPECIFICATIONS

CONTACT RATING: 100mA max, 42 VAC/DC
 ELECTRICAL LIFE: 2,000,000 cycles
 CONTACT RESISTANCE: 100mΩ max. (initial)
 INSULATION RESISTANCE: 1,000MΩ min.
 DIELECTRIC STRENGTH: 2,000VAC
 OPERATION FORCE: 3N ± 0.75N max

MATERIALS

SWITCH HOUSING: PBT (UL94 V-0)
 TRANSPARENT ACTUATOR: PC (UL94 V-0)
 ACTUATOR: ABS
 CONTACT: Stainless, As version tin-plated
 TERMINALS: Copper alloy, Au version tin-plated
 TERMINAL SEAL: Epoxy

INDEX
TOGGLE
ROCKER
SLIDE
PUSH BUTTON
DIP

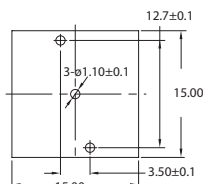
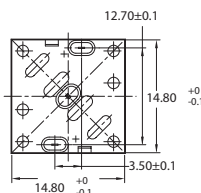
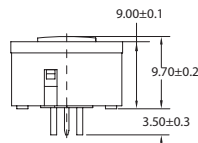
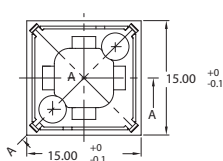

LT1-15-A0

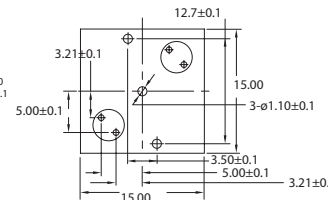
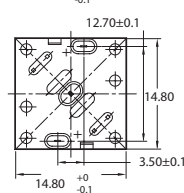
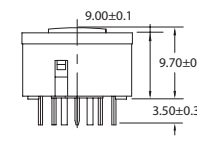
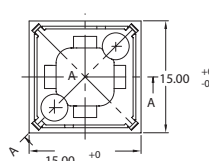

LT1-15-A2-**

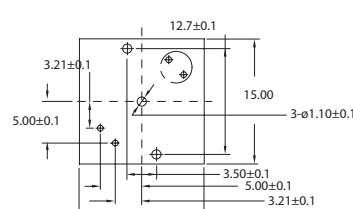
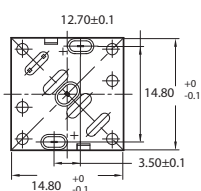
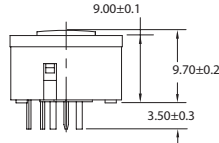
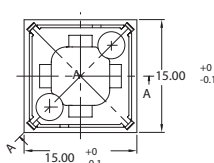

LT1-15-A1-*

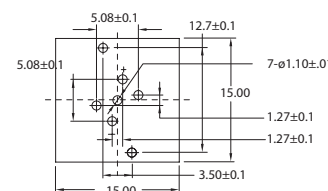
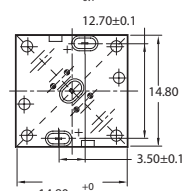
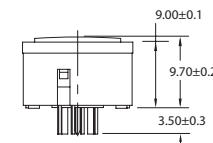
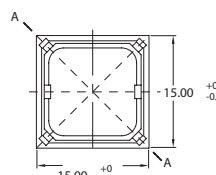

LT1-15-B*

HOW TO ORDER

A TYPE

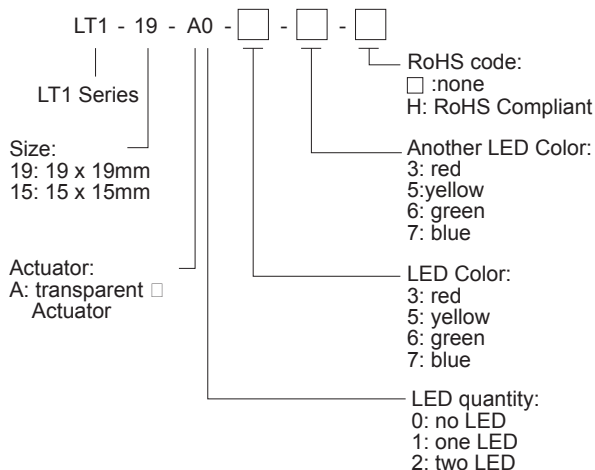

B TYPE

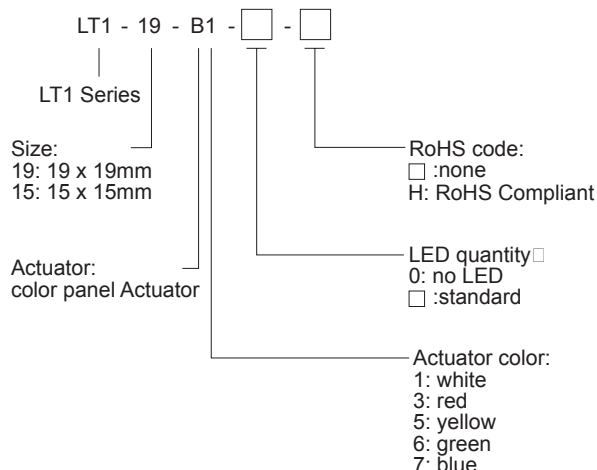

LT2

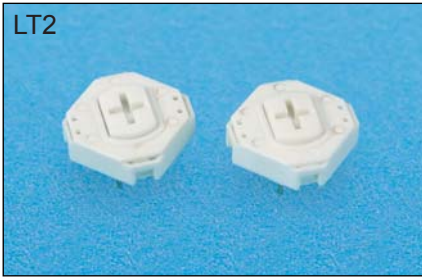

SPECIFICATIONS

CONTACT RATING: 100mA, 42VAC / DC
 ELECTRICAL LIFE: 2,000,000 cycles
 CONTACT RESISTANCE: 100mΩ max. (initial)
 INSULATION RESISTANCE: 1,000MΩ min.
 DIELECTRIC STRENGTH: 2,000VAC
 OPERATION FORCE: 3N±0.75N max.

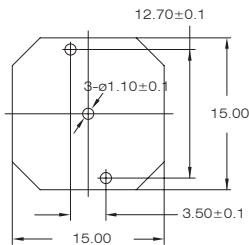
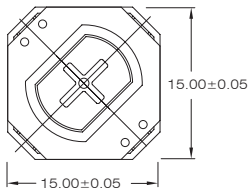
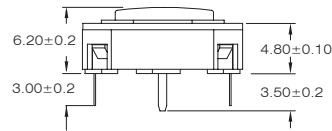
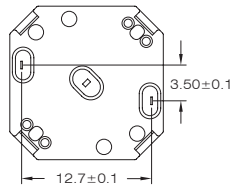

HOW TO ORDER

LT2 - 15 - - 2 - 3/3 -

LT2 Series

Size:
 19: 19 x 19mm
 15: 15 x 15mm

Plunger:
 T1/T2/T3

RoHS code:
 : none
 H: RoHS Compliant

Another LED color:
 3: red
 5: yellow
 6: green
 7: blue

LED color
 3: red
 5: yellow
 6: green
 7: blue

LED quantity:
 0: no LED
 1: one LED
 2: two LED

INDEX

TOGGLE

ROCKER

SLIDE

PUSHBUTTON

DIP

TACT